

## KANTHAL® FLOW HEATER KFH 2-30 HEATING GASES UP TO 1100°C

### TECHNICAL SPECIFICATION

#### SPECIFICATIONS

##### GENERAL

|  |                                  |  |  |
|--|----------------------------------|--|--|
| Model  | KFH 2-30-400                     |  |  |
| Article Number   | DFH100605 / DFH100606            |  |  |
| Directive  | Low Voltage Directive 2014/35/EU |  |  |
|  European Community | DIN EN 60519-1                   |  |  |
|  | DIN EN 60335-1                   |  |  |
| Usage ambient temperature  | 0...40 °C                        |  |  |
|  | 32...104 °F                      |  |  |



##### FLOW AND HEAT DETAILS

|                                      |                  |                        |                    |
|--------------------------------------|------------------|------------------------|--------------------|
| Gases and max. outlet temperature    | Air (dry, clean) | 1100 °C                | 2012 °F            |
|                                      | Nitrogen         | 1000 °C                | 1832 °F            |
|                                      | Argon            | 900 °C                 | 1652 °F            |
| Max inlet temperature                | All gases        | 50 °C                  | 122 °F             |
| Nominal flow rate (air)              | 81 kg/h          | 68 m <sup>3</sup> /h   | 1433 slm    40 cfm |
| Minimum air flow rate (air)          | 16.3 kg/h        | 13.6 m <sup>3</sup> /h | 227 slm    8 cfm   |
| Pressure drop (at nominal flow rate) | 12 kPas          | 120 mbar               | 1.8 psi            |
| Design operating pressure            | 150 kPas         | 1,5 bar abs            | 22 psi abs         |

##### OUTLET TEMPERATURE IN CLEAN AIR

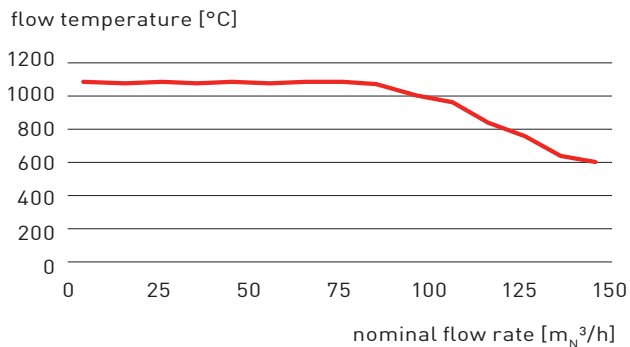

##### PRESSURE DROP IN CLEAN AIR

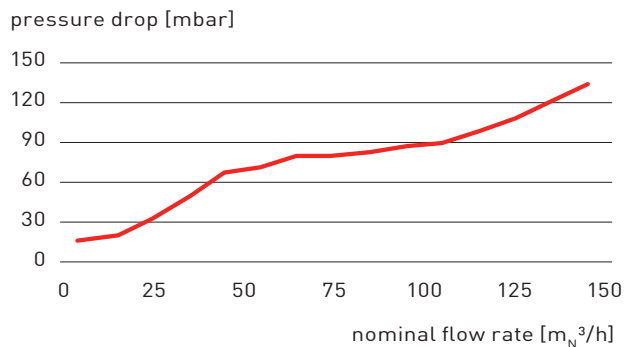

### ELECTRICAL DETAILS

|                           |   |       |
|---------------------------|---|-------|
| Nominal Voltage supply    | 400 V   | 3L    |
| Nominal Line Current      | 44 A  |       |
| Nominal Power             | 30 kW   |       |
| Power Cable               | 4G16 mm <sup>2</sup>  | 2.5 m |
| Recommended Power Control | PID control with fast reaction parameter settings and thyristor switch            |       |
| Protection Class          |  | 1     |
| Type of load              | Ohmic   |       |
| Thermocouple              | Type S with mini-plug   |       |

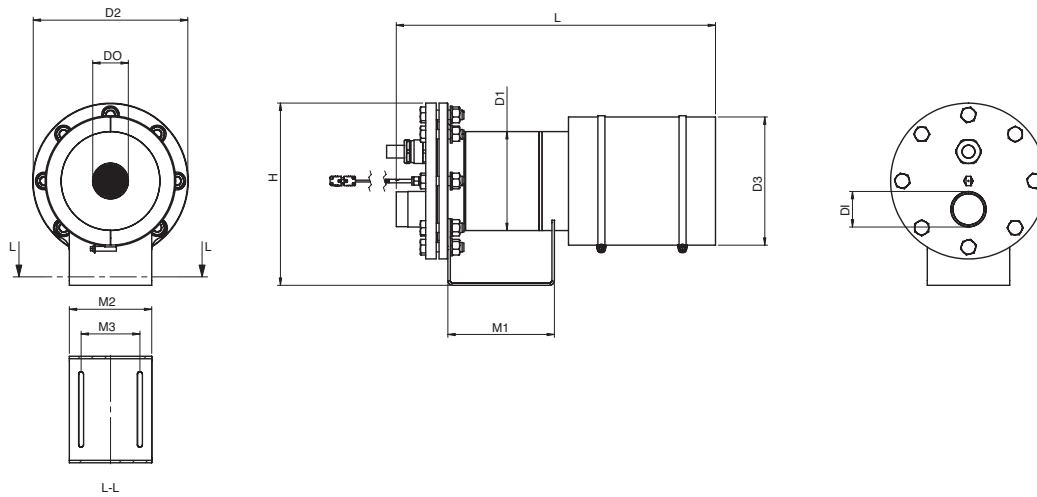

### MECHANICAL DETAILS

|             | L                       | H      | D1       | D2          | D3     | M1     | M2     | M3     |
|-------------|-------------------------|--------|----------|-------------|--------|--------|--------|--------|
| Dimensions  | 490 mm                  | 306 mm | 139.7 mm | 240 mm      | 190 mm | 175 mm | 140 mm | 100 mm |
| Flow Inlet  | R 1½" (external thread) |        |          | D1 Ø48.3 mm |        |        |        |        |
| Flow Outlet | 1½"                     |        |          | DO Ø48.3 mm |        |        |        |        |
| Weight      | 30 kg                   |        |          |             |        |        |        |        |

### SPARE PARTS

| DESCRIPTION                | ARTICLE NUMBER |
|----------------------------|----------------|
| Insulation set with clamps | DFH400142      |
| Nozzle Insulation          | DFH400140      |